

Work Instruction Number 109 - Workforce in Road signs (Rehabilitation Works)  
 All Amberon Traffic Management Installations or Removals on any main road or approaching road works 40mph and above (unless the site specific risk assessment deems it necessary on lower speeds of 40mph) must display the Workforce in Road signs in accordance with the following:  
 - Workforce in Road 'Slow' sign, this being the 1st Sign out and last sign in.

**WORKFORCE IN ROAD SLOW**

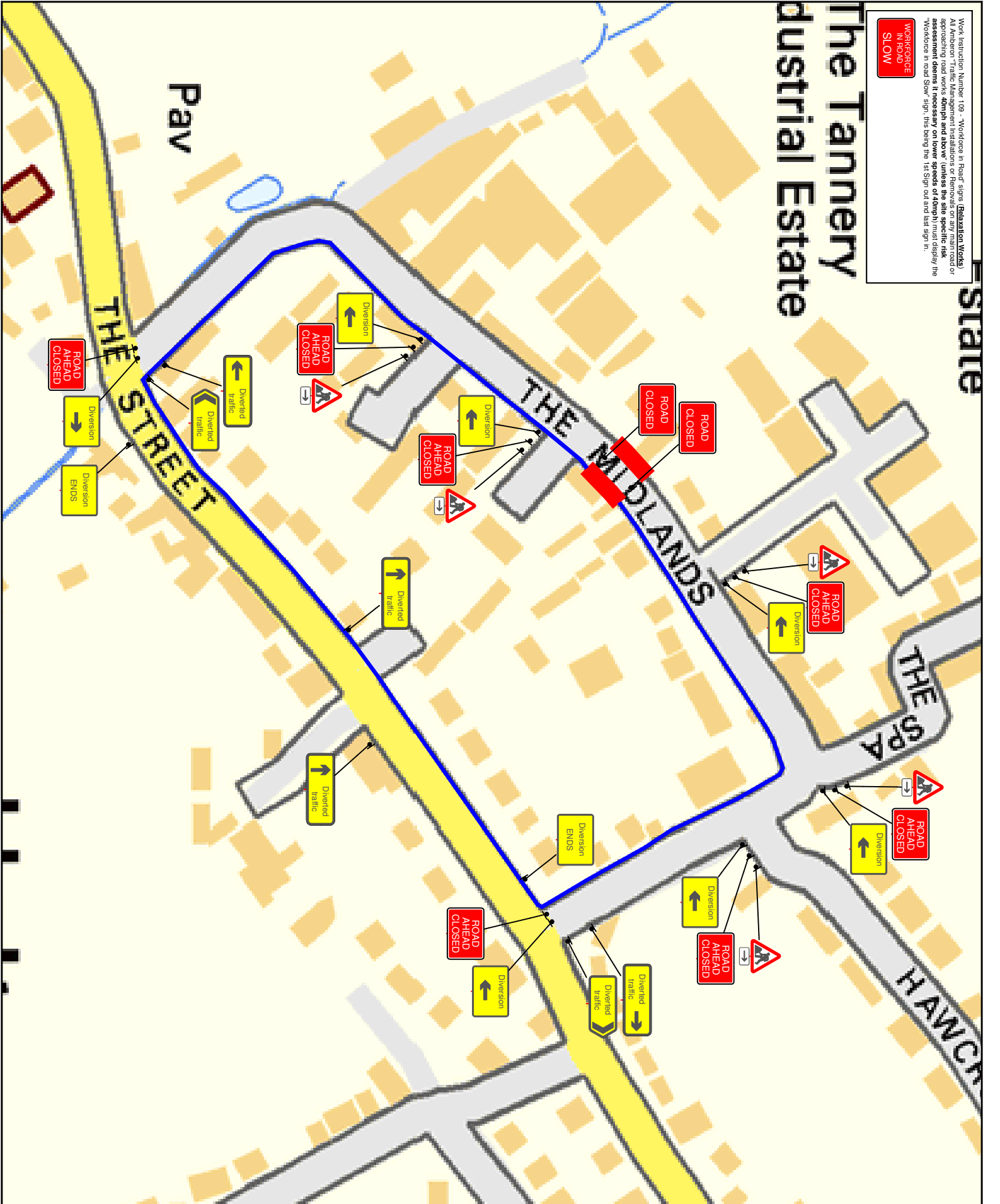

**TRAFFIC MANAGEMENT NOTES:**  
 1) All temporary traffic management shall be in accordance with Chapter 8 of the Traffic Signs Regulations and General Directions (TSRGD) 2019.  
 2) All temporary traffic management shall be in accordance with the Traffic Signs (Amendment) Regulations and General Directions 2019.  
 3) The signs shall be placed in accordance with the TSRGD and Road Works Act 1991.  
 4) All temporary traffic management signs should be located 450m min from the kerb face.  
 5) All temporary traffic management sign locations from the kerb face are stippled to on site approval from the Engineer.

**Key**

- Traffic sign
- Traffic cone/cylinder
- No waiting cone
- Pedestrian barrier
- Road closure
- Divergence route

Checked by: JElliott  
 Customer: CM Utilities  
 Job Reference: 126689  
 Location: The Midlands, Holt, Wiltshire, BA14 6RX  
 Date: 24.09.20  
 Description: Road Closure + Diversion  
 Scale: NTS  
 Amberon Ltd  
 Tel: 0945 571 5050

Produced By: L Morris  
 Drawing Ref: LM24.09.20.CPS4929  
 This drawing is the property of Amberon Ltd.

**Amberon Ltd**